

# SHERPA 60

# ARCADIA YACHTS



**PETREL GLOBAL SHIPS  
& BOATS TRADING LLC**

Office 621, 6th Floor Block A, Business Village.  
Port-Saeed Deira, Dubai UAE  
[www.petrel-global.com](http://www.petrel-global.com), tel.: +971 52 821 6411



**ARCADIA**  
YACHTS



**PETREL GLOBAL SHIPS  
& BOATS TRADING LLC**

Office 621, 6th Floor Block A, Business Village.  
Port-Saeed Deira, Dubai UAE  
[www.petrel-global.com](http://www.petrel-global.com), tel.: +971 52 821 6411

**SHERPA 60**



**ARCADIA**  
YACHTS



**PETREL GLOBAL SHIPS  
& BOATS TRADING LLC**

Office 621, 6th Floor Block A, Business Village.  
Port-Saeed Deira, Dubai UAE  
[www.petrel-global.com](http://www.petrel-global.com), tel.: +971 52 821 6411

**SHERPA 60**



**ARCADIA**  
YACHTS



**PETREL GLOBAL SHIPS  
& BOATS TRADING LLC**

Office 621, 6th Floor Block A, Business Village.  
Port-Saeed Deira, Dubai UAE  
[www.petrel-global.com](http://www.petrel-global.com), tel.: +971 52 821 6411

**SHERPA 60**

# TECHNICAL DATA

Type	Semi-displacement
Hull Material	GRP
LOA, m	18,67
Beam, m	5,58
Draught, m	1,32
Displacement, full load	33
Engines	2 x Volvo IPS 600 (700/800)
Cruising speed, knots	16 (18/19)
Max speed, knots	19 (21/22)
Generators	13,5 kW
Fuel tank, l.	3 400
Water tank, l.	730



LAYOUT

## ARCADIA SHERPA 60





# STANDARD LAYOUT

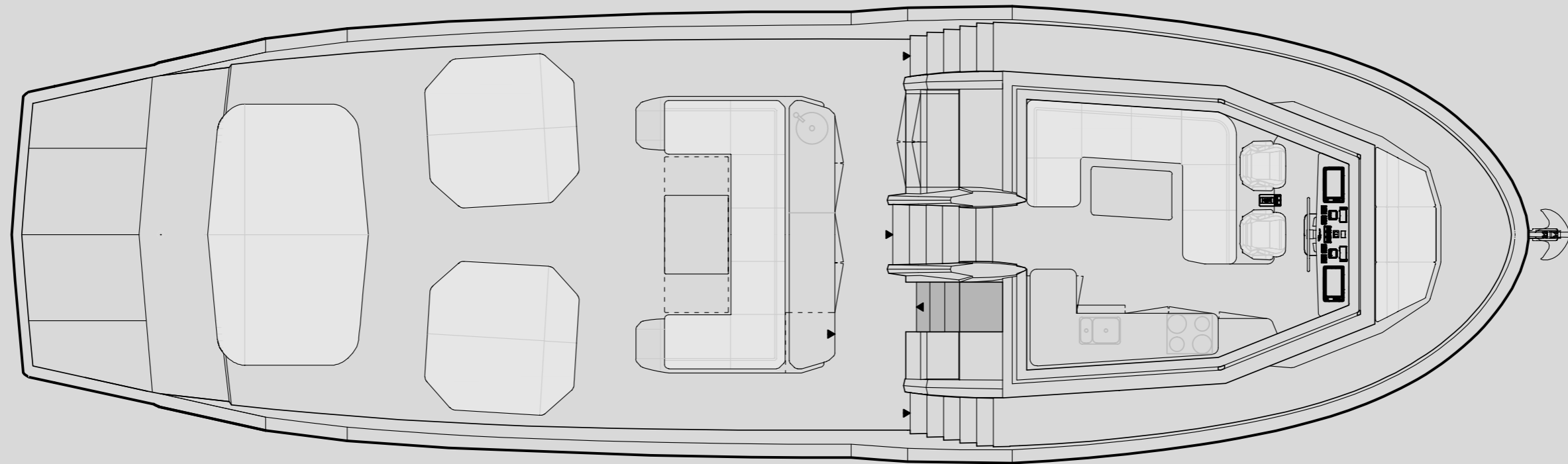

MAIN DECK

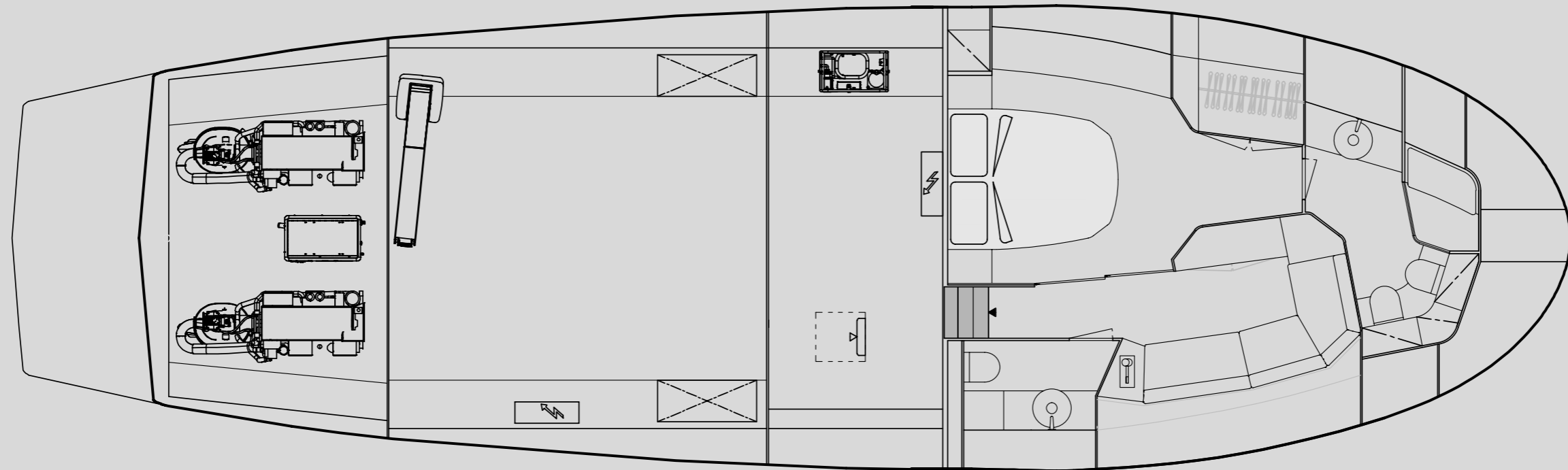

LOWER DECK





ДОСТУПНЫЕ ОПЦИОНАЛЬНЫЕ ИЗМЕНЕНИЯ



# OPTIONAL LAYOUT I

ДОСТУПНЫЕ ОПЦИОНАЛЬНЫЕ ИЗМЕНЕНИЯ

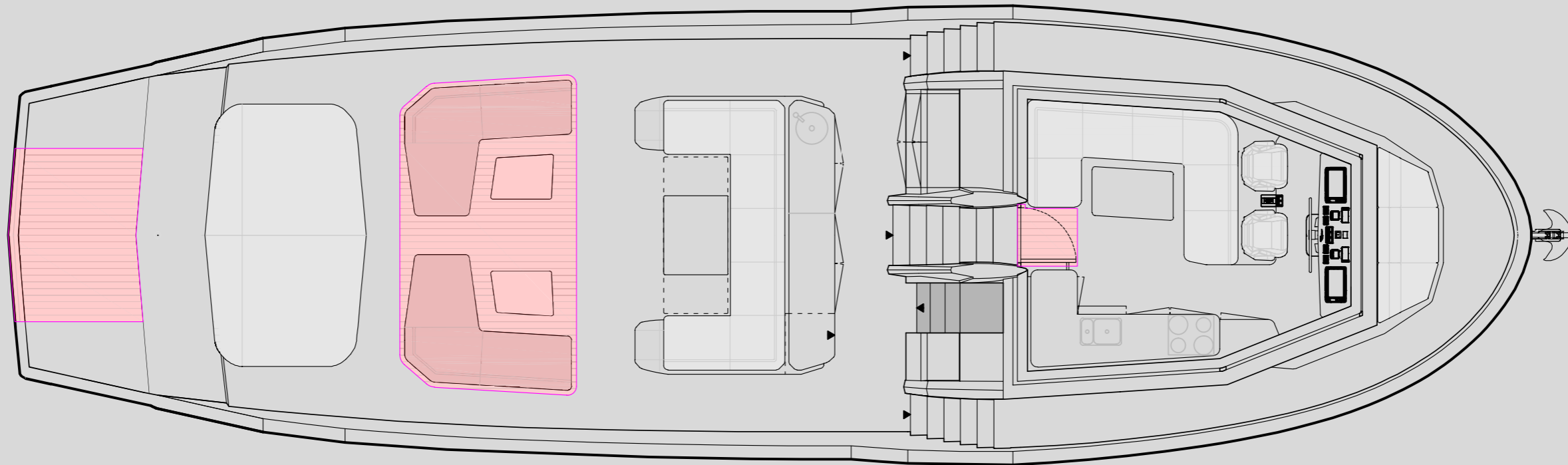

MAIN DECK

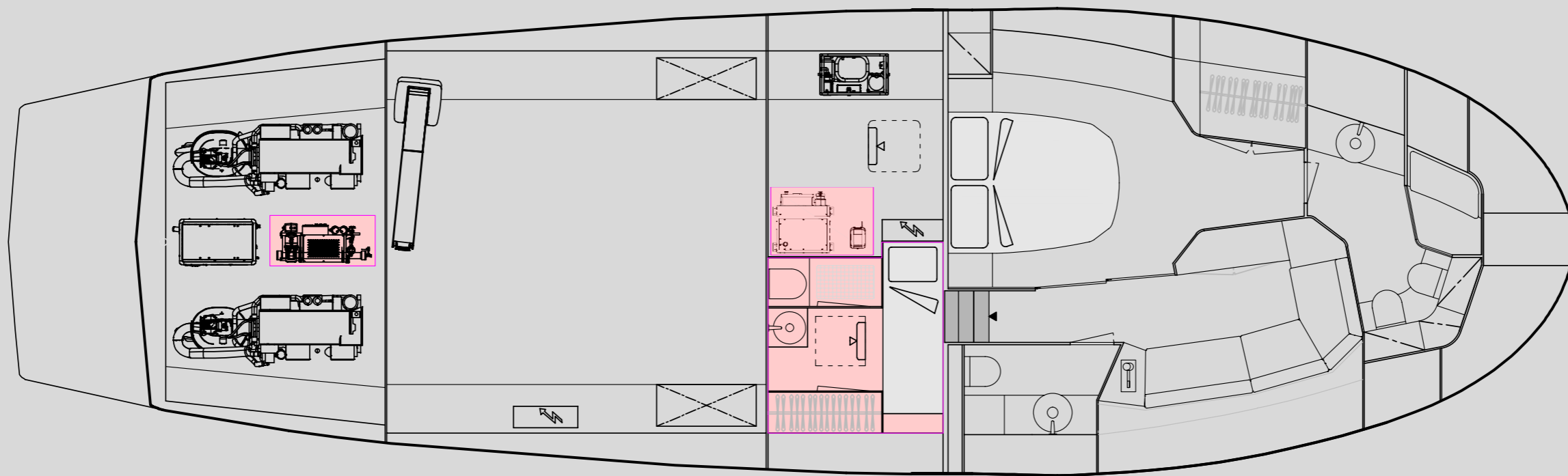

LOWER DECK



ДОСТУПНЫЕ ОПЦИОНАЛЬНЫЕ ИЗМЕНЕНИЯ

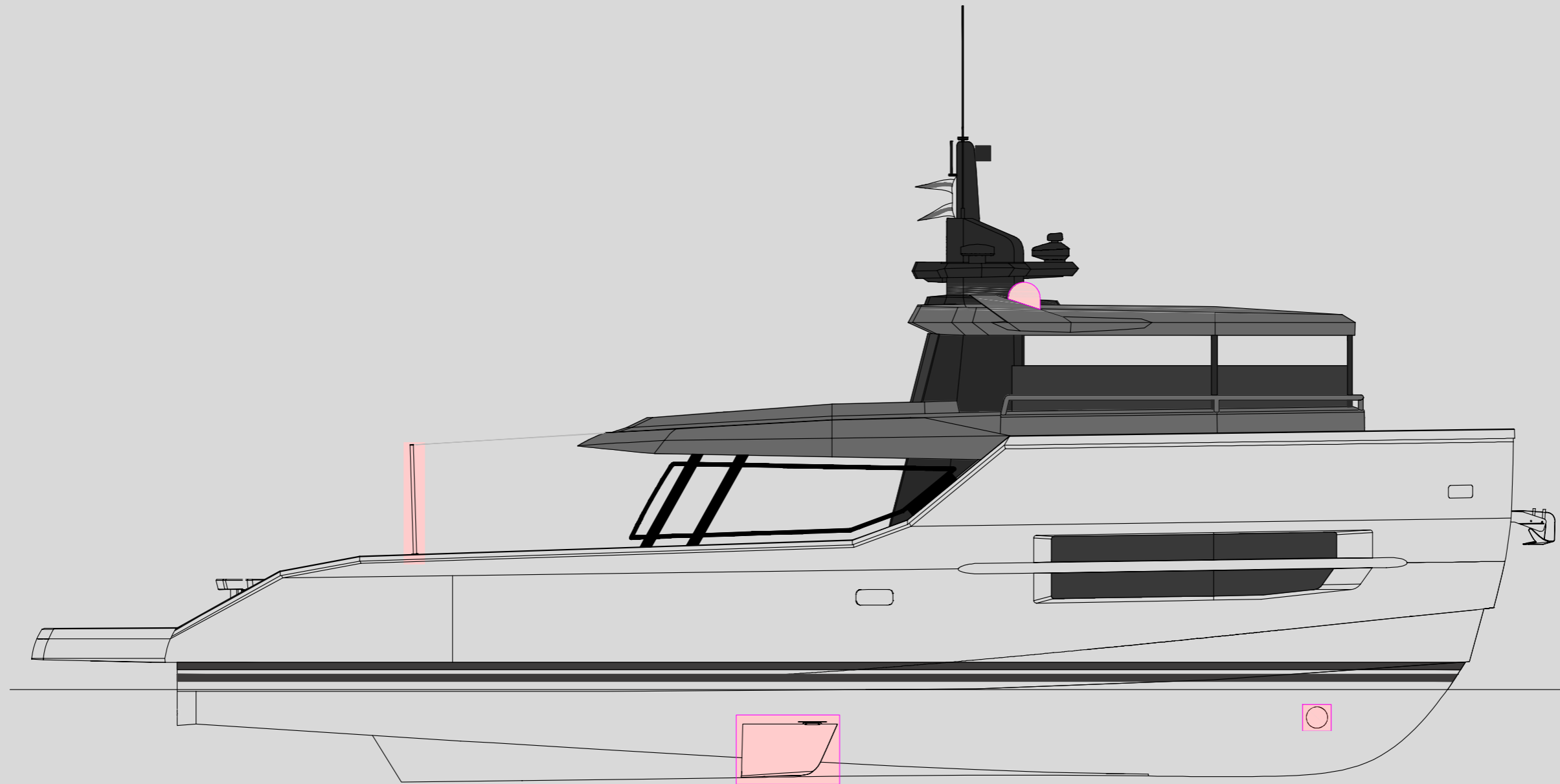

# OPTIONAL LAYOUT II

ДОСТУПНЫЕ ОПЦИОНАЛЬНЫЕ ИЗМЕНЕНИЯ

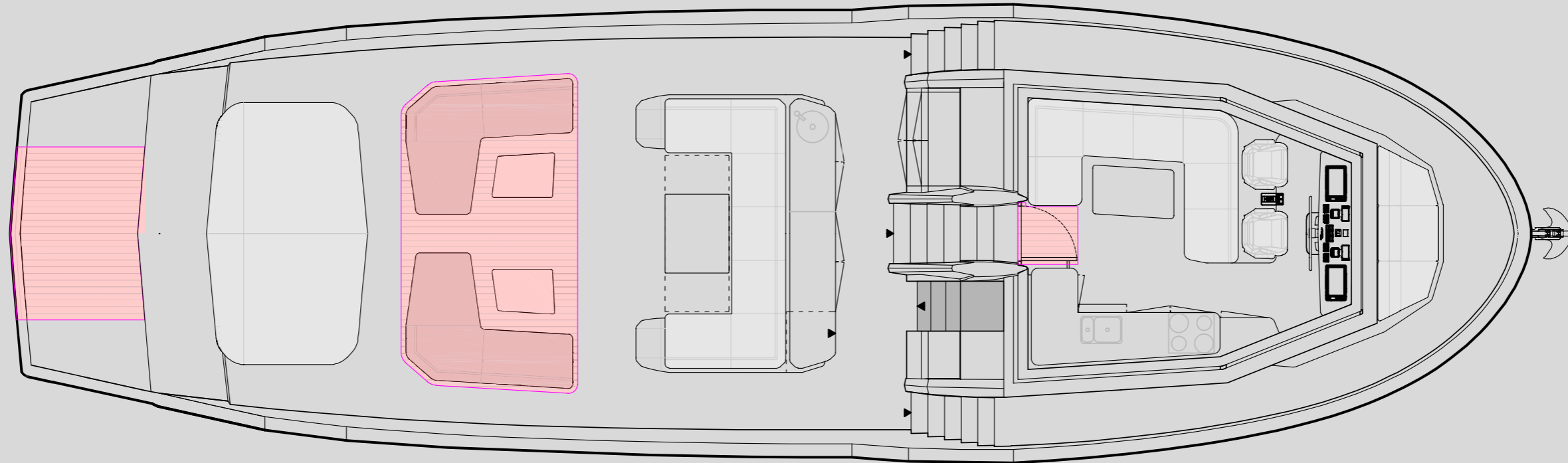

MAIN DECK

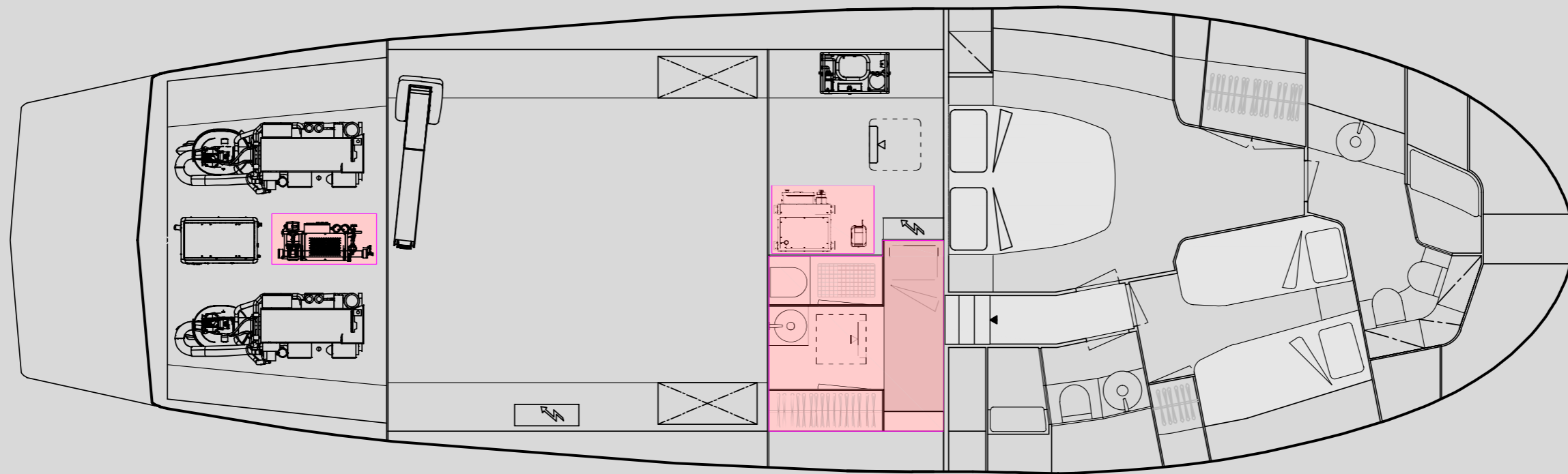

LOWER DECK







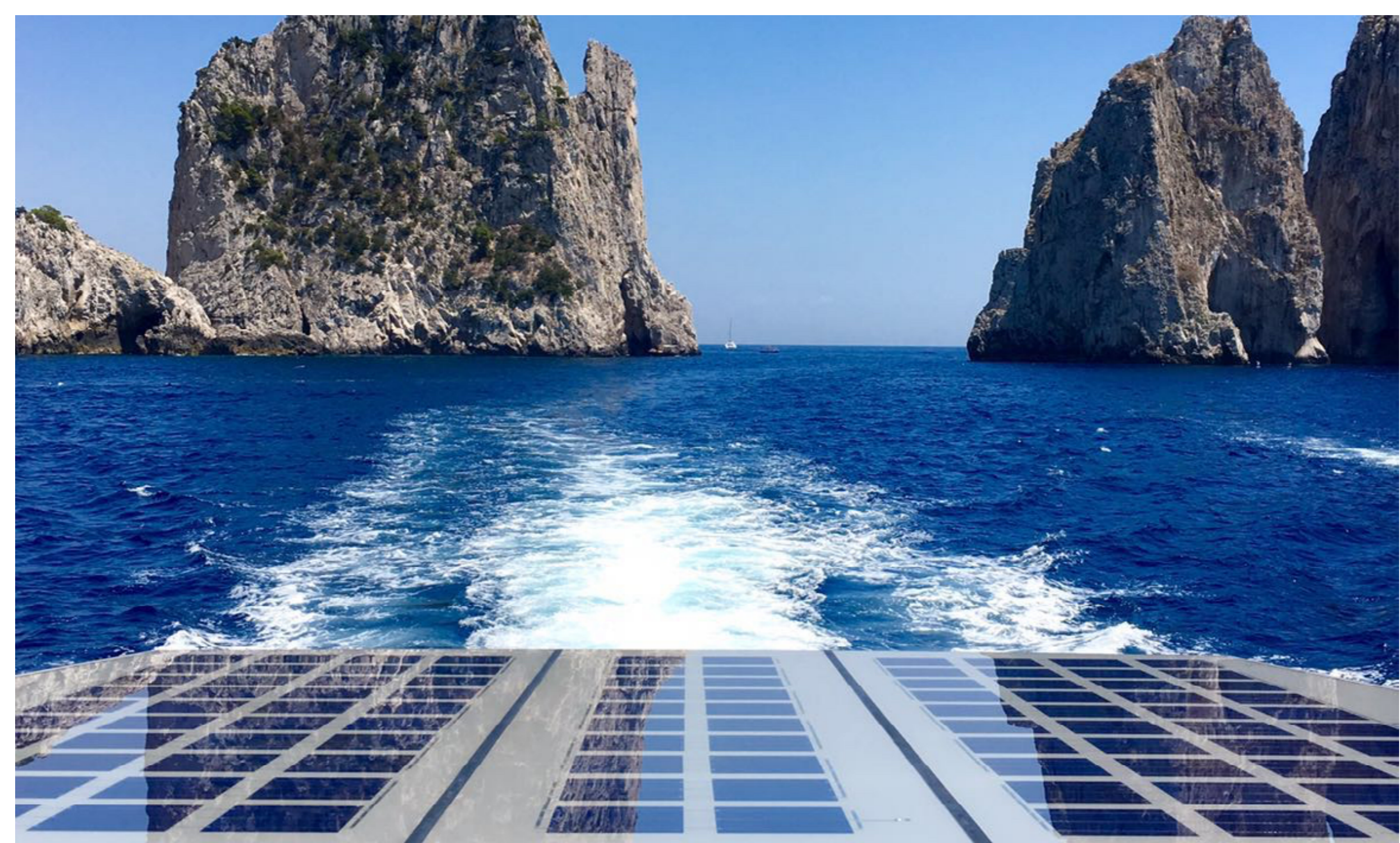

**ARCADIA**  
YACHTS



**PETREL GLOBAL SHIPS  
& BOATS TRADING LLC**

Office 621, 6th Floor Block A, Business Village.  
Port-Saeed Deira, Dubai UAE  
[www.petrel-global.com](http://www.petrel-global.com), tel.: +971 52 821 6411

**SHERPA 60**

15













**ARCADIA**  
YACHTS



**PETREL GLOBAL SHIPS  
& BOATS TRADING LLC**

Office 621, 6th Floor Block A, Business Village.  
Port-Saeed Deira, Dubai UAE  
[www.petrel-global.com](http://www.petrel-global.com), tel.: +971 52 821 6411

**SHERPA 60**

20



**ARCADIA**  
YACHTS



**PETREL GLOBAL SHIPS  
& BOATS TRADING LLC**

Office 621, 6th Floor Block A, Business Village.  
Port-Saeed Deira, Dubai UAE  
[www.petrel-global.com](http://www.petrel-global.com), tel.: +971 52 821 6411

**SHERPA 60**



ARCADIA  
YACHTS



**PETREL GLOBAL SHIPS  
& BOATS TRADING LLC**

Office 621, 6th Floor Block A, Business Village.  
Port-Saeed Deira, Dubai UAE  
[www.petrel-global.com](http://www.petrel-global.com), tel.: +971 52 821 6411

SHERPA 60

22



**ARCADIA**  
YACHTS



**PETREL GLOBAL SHIPS  
& BOATS TRADING LLC**

Office 621, 6th Floor Block A, Business Village.  
Port-Saeed Deira, Dubai UAE  
[www.petrel-global.com](http://www.petrel-global.com), tel.: +971 52 821 6411

**SHERPA 60**

23



**PETREL GLOBAL SHIPS  
& BOATS TRADING LLC**

Office 621, 6th Floor Block A, Business Village.  
Port-Saeed Deira, Dubai UAE  
[www.petrel-global.com](http://www.petrel-global.com), tel.: +971 52 821 6411