



**PETREL GLOBAL SHIPS  
& BOATS TRADING LLC**

Office 621, 6th Floor Block A, Business Village.  
Port-Saeed Deira, Dubai UAE  
[www.petrel-global.com](http://www.petrel-global.com), tel.: +971 52 821 6411



FERRETTI YACHTS 860





Composing a melody in which the notes of each individual instrument are beautifully orchestrated, Ferretti Yachts gears up to bring a new symphony to life: Ferretti Yachts 860. The flybridge yacht created by the Cattolica-based Shipyard features cutting-edge design and technology solutions, where the stylistic and architectural elements work together in harmony right down to the tiniest detail.

With upgraded Engines, Generators, Air Conditioning, Electronics along with furniture and cosmetic details this yacht is not only specified for the Gulf Regions but the Perfect yacht for the Gulf.

All duties are paid and the yacht is ready for handover to its new owner.

|                 |                      |
|-----------------|----------------------|
| Model Year      | 2025                 |
| Engines         | 2 x MAN V12          |
| Horsepower      | 2 x 2000 HP          |
| Engine hours    | 142 (as of Feb 2025) |
| Generator hours | 212 (as of Feb 2025) |
| Cabins          | 4                    |
| Crew            | 2                    |
| Registered      | UAE                  |



## TECHNICAL SPECIFICATIONS

|                    |                  |
|--------------------|------------------|
| Loa [m]            | 26.95   [88.5ft] |
| Max beam [m]       | 6.22   [20.5ft]  |
| Draft [m]          | 2.08   [6.10ft]  |
| Engines            | 2 x MAN V12      |
| Engine HP          | 2,000            |
| Transmission       | Shaft Drive      |
| Max speed [ kn]    | 31.5             |
| Cruise speed [ kn] | 27               |

|                              |               |
|------------------------------|---------------|
| Range [nm] at cruising speed | 300           |
| Material                     | GRP           |
| Fuel [l]                     | 7,000         |
| Water [l]                    | 1,400         |
| Generator                    | 2 x Onan 27kW |
| Cabins                       | 4             |
| Heads                        | 4             |
| Crew                         | 2             |





**PETREL GLOBAL SHIPS  
& BOATS TRADING LLC** Office 621, 6th Floor Block A, Business Village,  
Port-Saeed Deira, Dubai UAE  
www.petrel-global.com., tel.: +971 52 821 6411





**PETREL GLOBAL SHIPS  
& BOATS TRADING LLC**

Office 621, 6th Floor Block A, Business Village,  
Port-Saeed Deira, Dubai UAE  
[www.petrel-global.com](http://www.petrel-global.com), tel.: +971 52 821 6411





**PETREL GLOBAL SHIPS  
& BOATS TRADING LLC** Office 621, 6th Floor Block A, Business Village,  
Port-Saeed Deira, Dubai UAE  
[www.petrel-global.com](http://www.petrel-global.com), tel.: +971 52 821 6411





**PETREL GLOBAL SHIPS  
& BOATS TRADING LLC**

Office 621, 6th Floor Block A, Business Village,  
Port-Saeed Deira, Dubai UAE  
[www.petrel-global.com](http://www.petrel-global.com), tel.: +971 52 821 6411





**PETREL GLOBAL SHIPS  
& BOATS TRADING LLC** Office 621, 6th Floor Block A, Business Village,  
Port-Saeed Deira, Dubai UAE  
www.petrel-global.com., tel.: +971 52 821 6411

















**PETREL GLOBAL SHIPS  
& BOATS TRADING LLC**

Office 621, 6th Floor Block A, Business Village,  
Port-Saeed Deira, Dubai UAE  
[www.petrel-global.com](http://www.petrel-global.com), tel.: +971 52 821 6411













**PETREL GLOBAL SHIPS  
& BOATS TRADING LLC** Office 621, 6th Floor Block A, Business Village,  
Port-Saeed Deira, Dubai UAE  
www.petrel-global.com., tel.: +971 52 821 6411







**PETREL GLOBAL SHIPS  
& BOATS TRADING LLC** Office 621, 6th Floor Block A, Business Village,  
Port-Saeed Deira, Dubai UAE  
www.petrel-global.com., tel.: +971 52 821 6411

## ACCESSORIES

---

Cooking top upgrade: 5 rings, induction type

---

Oven 90 cm upgrade

---

Independent washer and dryer upgrade

---

Wine Cooler Dunavox Soul 72

---

Additional Flybridge Fridge

---

Grill gaggenau (single) on flybridge

---

Grill Teppanyaki on flybridge

---

Fridge 90cm diff.

---

Icemaker with internal water reservoir on flybridge

---

Multistandard sockets throughout the yacht

---

Generators upgrade (2 x 27kW) with racor filter and smoke separator

---

Shore fresh water intake

---

---

Shore power 220V with 63A cable

---

Watermaker Idromar 180LT/H

---

Teak at bow around anchors

---

Predisposition cables for backlit name

---

Hard top with Shading blades

---

Painting of teak tables

---

Teak on flybridge deck with black caulking

---

Primer application under antifouling

---

Awning system with carbon poles on flybridge

---

Awning system with carbon poles for bow dinette

---

Awining system with carbon poles on transom

---

Side underwater lights - couple x 2

---





## ACCESSORIES

---

Stern underwater lights - couple

---

Copilot seat by Potrona Frau on flybridge

---

Bow dinette convertible in sunpad

---

Teak table upgrade on flybridge

---

Painting of navigation equipment

---

Courtesy lights and dimmers for exteriors

---

Side deck doors (port & starboard side)

---

Electric searchlight

---

Retractable cleats on aft platform (not for mooring) - couple

---

Air extractor throughout the bathrooms

---

Air conditioning Super tropical (144.000 BTU, incl. all bathrooms)

---

Manual glass door on salon starboard side

---

---

Sliding beds on port side guest cabin

---

Additional insulation for master cabin

---

Electric curtains for salon

---

Electric curtains and blackout (Vip & guests)

---

Electric curtains and blackout in master cabin

---

Copilot seat by Potrona Frau in wheelhouse

---

Courtesy lights and dimmers for interiors

---

Deletion bidet and centralized WC

---

Diff Gerberit WC

---

Mosquito nets on portholes

---

Light LED at bow salon

---

Electric sliding salon door upgrade

---



## ACCESSORIES

---

Stair Glass

---

Engines Upgrade - 2 x MAN V12 2,000HP (diff than standard)

---

EAPP MAN Engines

---

Premium internet package + 5G

---

Upgraded audio at bow

---

2 Empty Domes + black painting

---

TV 75" in salon

---

TV 43" Mirror in VIP cabin

---

TV 55" Mirror in Master cabin

---

TV 43" Mirror in starboard side guest cabin

---

Antenna TV SAT predisposition (salon and cabins)

---

Stern hydraulic thruster 30 Hp

---

---

NAVIOP control upgrade

---

SIMRAD Touch full upgrade system

---

AIS transponder SIMRAD NAIS500 (RX -TX)

---

Anti - collision System Watchit

---

CCTV camera kit and switch

---

Cockpit control station

---

Gyro stabilizers SEAKEEPER NG 18

---

Jet ski launching system

---

Tender launching system

---

Parquet custom flooring for main deck

---

Saloon wall at bow in Florim diff

---

Dayhead sink top diff.

---





## ACCESSORIES

---

Top Vanity in the master cabin additional

---

Top Vanity in the cabin additional

---

Marble in master bathroom diff

---

VIP & Guest Bathroom Florim diff.

---

Top baths diff. from std

---

Venetian blinds diff from std

---

Open Galley Ernesto Meda with side in fumè glass

---

Galley Ernesto Meda in wood and Florim

---

Decorative cushions

---

Armchair in saloon

---

Coffee Table diff in saloon

---

Dining Table diff

---

Williams 395 Tender – Carbon Black

---

---

Dining chairs diff (qt8)

---

Decorative rug in md

---

Master sofa upholstery diff

---

Pouf in master cabin diff

---

Master bedhead diff.

---

Bedhead Guests Cab R/L DIFF

---

Bedhead Vip Cabin DIFF

---

Sofa terrace fly aft

---

Sofa bow fly white

---

Exterior loose furniture 6 armchairs Roda Orson

---

External coffee table add

---

Documentation for CEE Export

---

Hand Shower for Toilet in Master Cabin

---





**PETREL GLOBAL SHIPS  
& BOATS TRADING LLC** Office 621, 6th Floor Block A, Business Village,  
Port-Saeed Deira, Dubai UAE  
www.petrel-global.com., tel.: +971 52 821 6411





**PETREL GLOBAL SHIPS  
& BOATS TRADING LLC**

Office 621, 6th Floor Block A, Business Village,  
Port-Saeed Deira, Dubai UAE  
[www.petrel-global.com](http://www.petrel-global.com), tel.: +971 52 821 6411

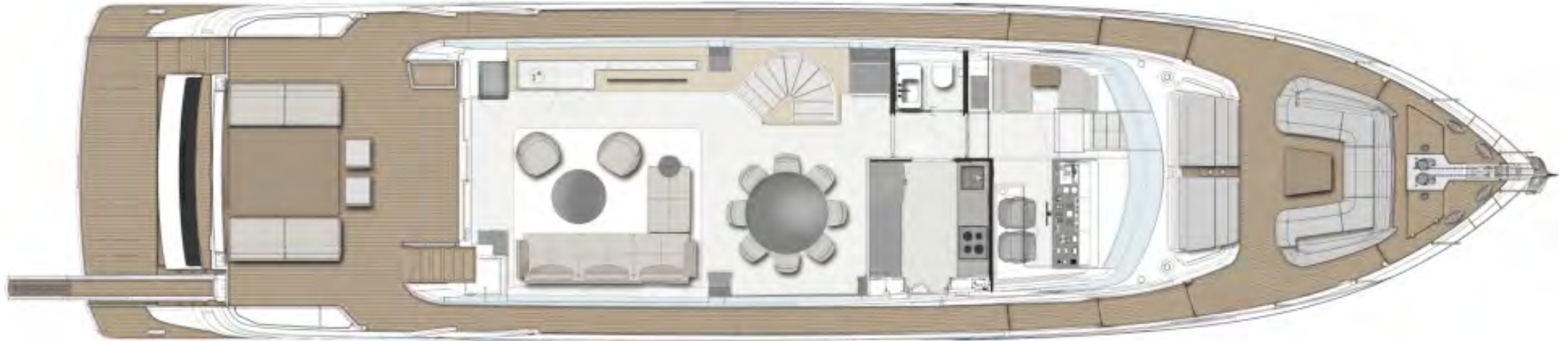

**PETREL GLOBAL SHIPS  
& BOATS TRADING LLC**

Office 621, 6th Floor Block A, Business Village,  
Port-Saeed Deira, Dubai UAE  
www.petrel-global.com., tel.: +971 52 821 6411









# FERRETTI YACHTS 860



**PETREL GLOBAL SHIPS  
& BOATS TRADING LLC**

Office 621, 6th Floor Block A, Business Village,  
Port-Saeed Deira, Dubai UAE  
[www.petrel-global.com](http://www.petrel-global.com), tel.: +971 52 821 6411