







# TECHNICAL DATA

## ENGINES

2 x VOLVO PENTA D13 1000 h.p.

## DIMENSIONS

LOA **18,24 M**

LH **16,90**

Max beam **5,00 M**

## SPEED AND RANGE

Max speed **32 kn**

Cruise speed **26 kn**

Range **400 nm**

Unladen displacement **29.5 T**

Draft **1,50 M**

Fuel **3 250 л**

Fresh water **700 л**

People on board **14**

Design category **A**

Number of cabins **3 + 1**

Hull material **GRP**



LAYOUT

# FERRETTI YACHTS 580





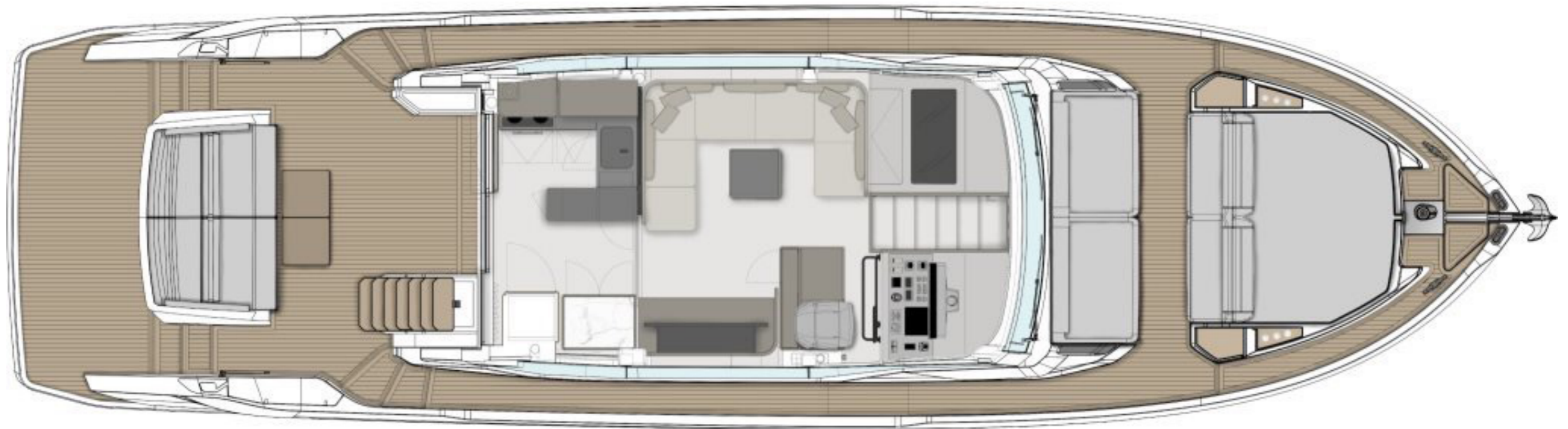
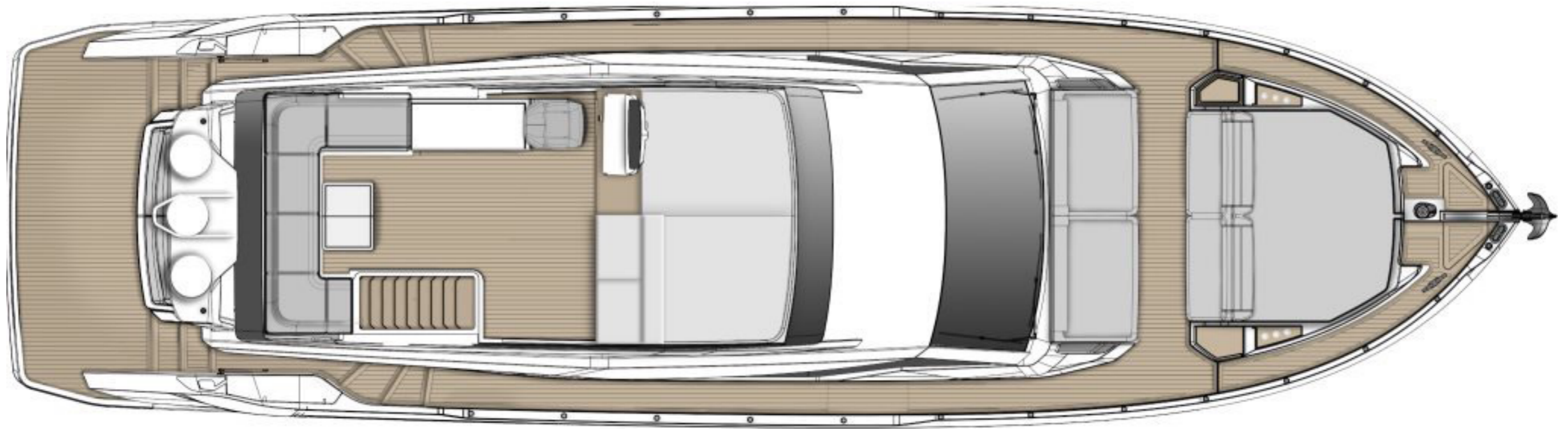















SPECIFICATION

FERRETTI YACHTS 580



# INSTALLED ADDITIONAL OPTIONS PACKAGE

## Exterior Painting & Accessories

Anchor upgrade (50 kg, 120 mt chain) Bimini top: stainless steel bimini top on flybridge with LED lighting  
Courtesy lights for outdoor areas  
GRP covering for cockpit mooring stations  
Mooring winch - couple  
Painting of navigation equipments  
Primer application under antifouling  
Teak on flybridge deck with black caulking  
Teak on lifting platform with black caulking  
Teak side decks and bow and cockpit shelves  
Teak table with folding top upgrade on flybridge  
Underwater lights - couple  
Waterproof covers for external cushions and tables  
Winch upgrade on bow, 2300W

## Appliances

Combined washer/dryer in laundry column  
Cooking top on flybridge  
Dishwasher  
Grill on flybridge  
Icemaker with internal water reservoir in cockpit  
Refrigerator on flybridge

## Electrical & Technical Equipment

Generator upgrade  
German Schuko sockets throughout the yacht  
Grey water system with tank  
Inverter/battery charger  
Shore fresh water intake  
Watermaker 180 L/h with control at main helm

## Interior Comfort & Furniture

Copilot seat by Poltrona Frau in wheelhouse  
Courtesy lights for interiors  
Crew cabin  
Electric curtains and blackout in Master cabin  
Electric curtains in salon  
Hand shower for toilet 2  
Mosquito nets on portholes  
Salon sofa on starboard side with tv lift  
Tropical air conditioning

## Stabilizer

Gyro stabilizers

## Navigation, Security & Telecommunication

AIS transponder Simrad NAIS500 (RX-TX)  
Cockpit control station  
Digital chain counter  
Joystick at 2 helm stations (Bow and stern thruster with proportional propellers included)  
Radar antenna radome Broadband 4G  
Simrad autopilot control unit  
Simrad display upgrade

## Audio-Video & Entertainment

Internet upgrade  
Premium audio for exteriors  
TV 43" in VIP cabin  
TV 50" Master Cabin

## Transom equipment, water toys and ancillaries

Concealed gangway  
Lifting platform



**PETREL GLOBAL SHIPS  
& BOATS TRADING LLC**

Office 621, 6th Floor Block A, Business Village.  
Port-Saeed Deira, Dubai UAE  
[www.petrel-global.com](http://www.petrel-global.com), tel.: +971 52 821 6411

580